

# 15 mm Miniature Solenoid Valves

## Standard 2- & 3-Way Series

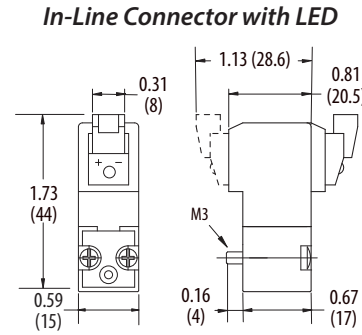

**Suggested Manifold Dimensions**

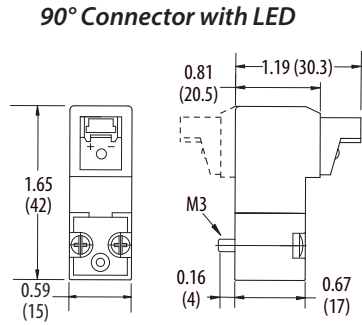
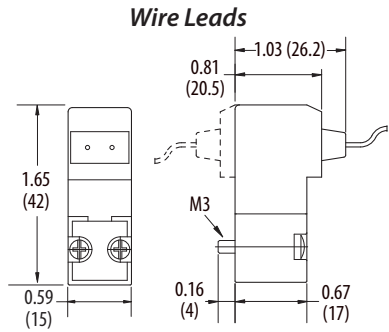
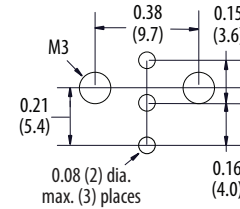

**Pneumatic Interface**

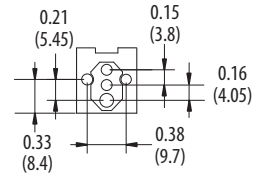

## Standard 2- & 3-Way Series

## Latching 2- & 3-Way Series

**DIN Connector 43650 Form C**

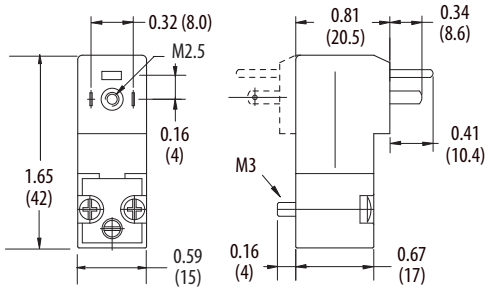

**Terminal Connector (Ind. Form)**

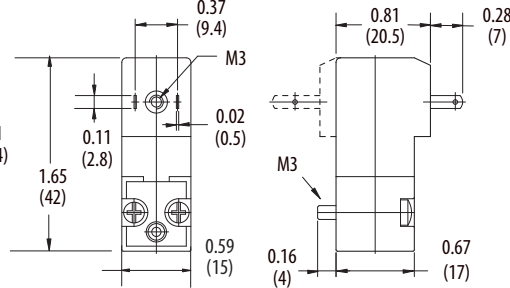

**Wire Lead**

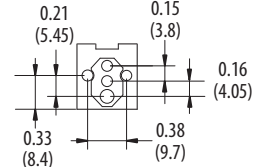
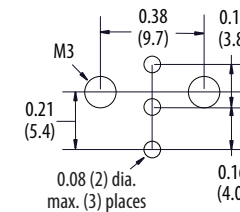
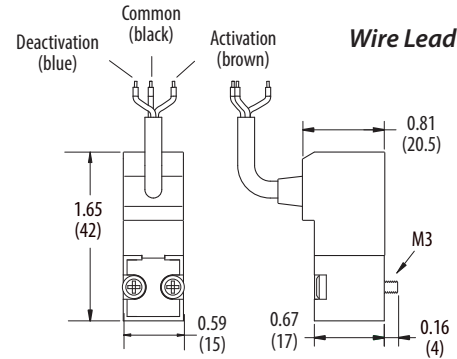

## High Flow 2-Way Series

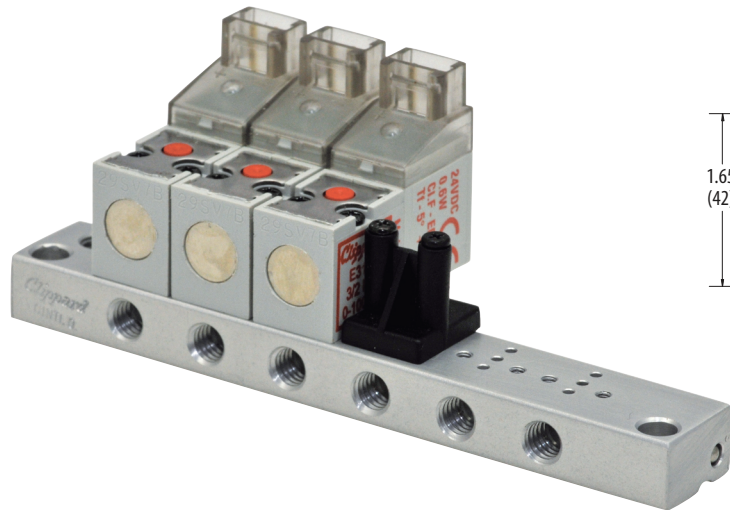

**90° Connector with LED**

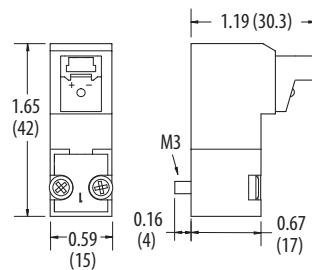

**In-Line Connector with LED**

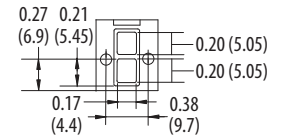
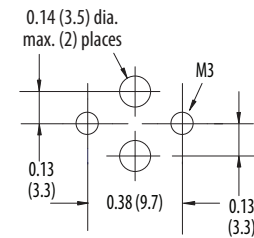
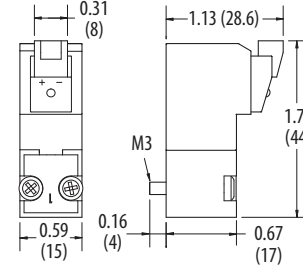

**Clippard**

877-245-6247 | clippard